

*Bisco*

CE

# **DUAL-SYRINGE**

## Instructions for Use



BISCO, Inc.  
1100 W. Irving Park Rd.  
Schaumburg, IL 60193  
U.S.A.  
847-534-6000  
1-800-247-3368

IN-090R7  
Rev. 10/16

**Caution:** U.S. Federal law restricts this device to sale by or on the order of a licensed Dentist.

# DUAL-SYRINGE DELIVERY SYSTEM

## GENERAL INFORMATION

The DUAL-SYRINGE delivery system allows for a consistent mixture of Base and Catalyst when using the static mixing tip. It offers convenience, allowing the dentist to deliver the material directly into the preparation/restoration, while controlling the amount of material extruded.

Refer to the product Instruction Sheet for material-specific GENERAL INFORMATION, INDICATIONS, AND INSTRUCTIONS FOR USE.

## INSTRUCTIONS FOR USE

1. Remove cap from the DUAL-SYRINGE by rotating in a counter-clockwise direction and pulling off.
2. For first time use of DUAL-SYRINGE: Dispense the first 2-3mm of material onto a mixing pad to ensure a homogeneous mixture of material.
3. Place static mixing tip by lining up notch in tip hub (A) with the syringe notch (B) and rotating in a clockwise direction until it is in a locked position.

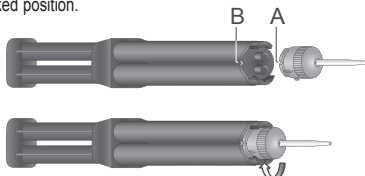

4. OPTION 1: Syringe material into preparation or restoration using static mixing tip.  
OPTION 2: For intraoral delivery using a Unit-Dose Tip: Place a unit-dose tip at the static mixing tip opening and syringe material into the unit-dose tip. Place plugger and insert tip into a unit-dose syringe.
5. **The DUAL-SYRINGE static mixing tip should be left in place until the next application. If used intraorally, it should be wiped with disinfectant prior to storage. Prior to placing a new tip on the syringe, dispense 2-3 millimeters of both base and catalyst onto a mixing pad.**

**HYGIENE:** Use of commonly available hygienic protective covering to avoid any contamination of syringes during treatment is recommended.

**DISPOSAL:** Refer to community provisions relating to waste. In their absence, refer to national or regional provisions relating to waste.

**WARRANTY:** BISCO, Inc. recognizes its responsibility to replace products if proven to be defective. BISCO, Inc. does not accept liability for any damages or loss, either direct or consequential, stemming from the use of or inability to use the products as described. Before using, it is the responsibility of the user to determine the suitability of the product for its intended use. The user assumes all risk and liability in connection therewith.

BISCO, INC.  
1100 W. Irving Park Rd.  
Schaumburg, IL 60193  
U.S.A.  
1-800-247-3368  
847-534-6000  
www.bisco.com



BISICO France  
120, allée de la Coudoulette  
13680 Lançon De Provence  
France  
Tél. : 33-4-90-42-92-92